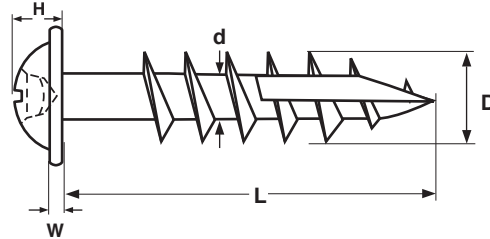
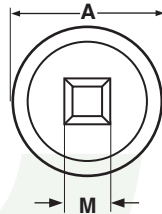

## WOOD SCREWS

**Round Washer Square  
Recess, Coarse Thread**
**TYPE-17 FACE FRAMING**

**ROUND WASHER SQUARE RECESS COARSE THREAD FACE FRAMING SCREW**

Nominal Diameter and Approximate # of Threads per Inch	A		H		W	D		d		M		Recess Size
	Washer Diameter		Total Head Height		Washer Thickness	Major Diameter		Minor Diameter		Recess Width		
	Max	Min	Max	Min	Ref	Max	Min	Max	Min	Max	Min	
8 - 9	0.385	0.355	0.133	0.108	0.035	0.181	0.165	0.110	0.094	0.099	0.65	#2
<b>Tolerance on Length</b>		<b>Nominal Length</b>				<b>Tolerance</b>						
		1.25" thru 1.5"				±0.05						

<b>Description</b>	An externally threaded fastener with a dome-shaped head with a square recess and an integrally formed washer. The shank has an unthreaded section directly below the head, a coarse thread pitch and a chip cavity cut out where the final several threads, ending at the tip.
<b>Applications / Advantages</b>	The coarse thread variety is designed for use in soft woods, particle board and plywood. The round washer head provides the maximum bearing surface to fasten it tightly into the pocket. These are also referred to as "pocket hole" screws due to the type of hole into which the fastener is inserted. Such holes are drilled at an angle of approximately 15° into one workpiece and joined to the other piece by the screw. Such fastening methods don't require access to the inside of the joint to make repairs or adjustments.
<b>Material</b>	C1022 (or equivalent) case-hardened steel
<b>Surface Hardness</b>	Vickers HV 450 minimum
<b>Torque</b>	39 in.-lbs. minimum
<b>Plating</b>	See Appendix-A for plating information