

Steel

Beveled

Washers

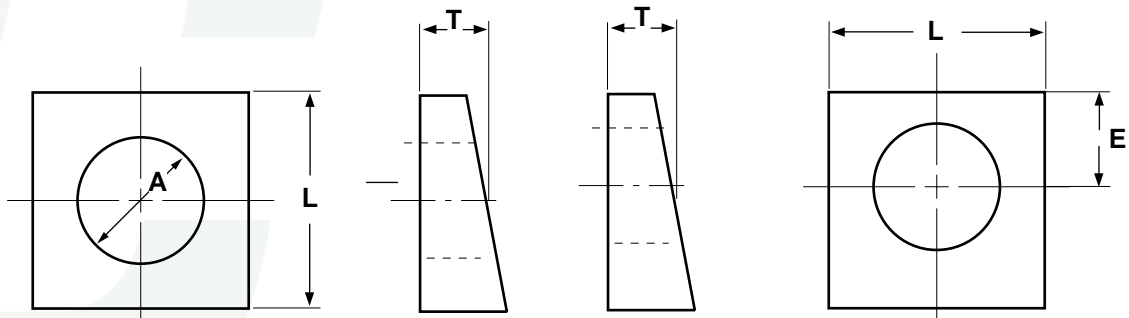

Square Beveled

Clipped Square Beveled

HARDENED BEVELED WASHERS					ASME B18.2.6-1996		
Nominal Washer Size		Inside Diameter - A			L Minimum Side Length	T Thickness	E Minimum Edge Distance
		Basic	Tolerance				
			Plus	Minus			
1/2	0.500	0.531	0.0313	0	1.750	0.313	0.438
5/8	0.625	0.688	0.0313	0	1.750	0.313	0.547
3/4	0.750	0.813	0.0313	0	1.750	0.313	0.656
7/8	0.875	0.938	0.0313	0	1.750	0.313	0.766
1	1.000	1.125	0.0313	0	1.750	0.313	0.875
1-1/8	1.125	1.250	0.0313	0	2.250	0.313	0.984
1-1/4	1.250	1.375	0.0313	0	2.250	0.313	1.094
1-3/8	1.375	1.500	0.0313	0	2.250	0.313	1.203
1-1/2	1.500	1.625	0.0313	0	2.250	0.313	1.313

Description	A flat washer which can be square or circular, with one bearing surface having an oblique angle.
Applications/ Advantages	Commonly used when fastening bolts through the flanges of "I" beams.
Material	Washers shall be made from a carbon steel which conforms to the following chemical composition requirements (heat analysis): <i>Phosphorus</i> : 0.040% maximum; <i>Sulfur</i> : 0.050% maximum
Hardness	Plain or Zinc-plated - Rockwell C 38 - 45 Hot-Dip Galvanized - Rockwell C 26 - 45
Plating	See Appendix-A for plating information.