

THUMB & WING SCREWS

Knurled with Washer Face

THUMB SCREWS

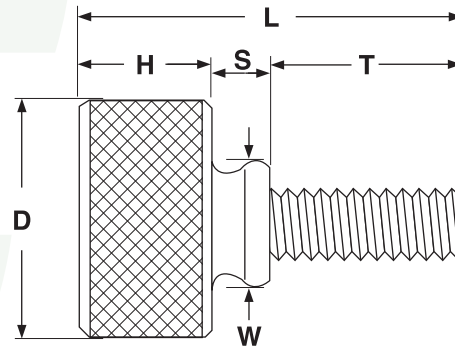

| KNURLED THUMB SCREWS WITH WASHER FACE | | | | | | | | | | | |
|---------------------------------------|---------------|------|-------------|------|----------------|------|---------------|------|--------------------|-------------------|------|
| Thread Size x Thread Length | D | | H | | L | | T | | S | W | |
| | Head Diameter | | Head Height | | Overall Length | | Thread Length | | Shoulder Length | Washer Face Width | |
| | Max | Min | Max | Min | Max | Min | Max | Min | Ref | Max | Min |
| 4-40 x 5/16 | .395 | .375 | .203 | .173 | .640 | .610 | .322 | .302 | .125 | .406 | .344 |
| 4-40 x 3/8 | .395 | .375 | .203 | .173 | .703 | .672 | .385 | .365 | | | |
| 4-40 x 7/16 | .395 | .375 | .203 | .173 | .765 | .735 | .448 | .428 | | | |
| 6-32 x 5/16 | .395 | .375 | .203 | .173 | .640 | .610 | .322 | .302 | | | |
| 6-32 x 3/8 | .395 | .375 | .203 | .173 | .703 | .672 | .385 | .365 | | | |
| 6-32 x 7/16 | .395 | .375 | .203 | .173 | .765 | .735 | .448 | .428 | | | |
| 6-32 x 1/2 | .395 | .375 | .203 | .173 | .828 | .797 | .510 | .490 | | | |
| 8-32 x 3/8 | .458 | .437 | .203 | .173 | .703 | .672 | .385 | .365 | | | |
| 8-32 x 7/16 | .395 | .375 | .203 | .173 | .765 | .735 | .448 | .428 | | | |
| 8-32 x 1/2 | .458 | .437 | .203 | .173 | .828 | .797 | .510 | .490 | | | |
| 8-32 x 5/8 | .458 | .437 | .203 | .173 | .953 | .922 | .635 | .615 | | | |
| 10-32 x 3/8 | .520 | .500 | .203 | .173 | .703 | .672 | .385 | .365 | | | |
| 10-32 x 1/2 | .520 | .500 | .203 | .173 | .828 | .797 | .510 | .490 | | | |
| 10-32 x 5/8 | .520 | .500 | .203 | .173 | .953 | .922 | .635 | .615 | | | |

| | | |
|----------------------------------|--|------------------------|
| Description | A one-piece screw with a cylindrically-shaped head, a fully-threaded shank with a unified thread pitch, and a shoulder section that separates the two. The head has a smooth, flat top and a roughened surface around its full circumference. The shoulder has two sections, the wider of the two which serves as a washer face directly above the threaded shank. | |
| Applications / Advantages | For use in applications where periodic manual adjustment is required and where finger pressure can supply sufficient tightening torque. The washer face-design allows the head of the screw to seat flush against the mating surface and guards against over-tightening the screw which could strip the mating threads. | |
| Material | 303 Stainless Steel | Aluminum Alloy 6061 T6 |
| Plating | Parts are typically supplied without any additional coating or finish. | |