

METRIC FASTENERS

Type 9070 Round
Coupling Nuts

NUTS

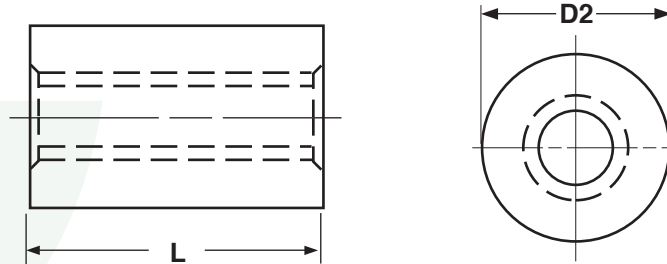

TYPE 9070 ROUND COUPLING NUTS			
Nominal Diameter and Thread Pitch	Part Number	D2	H
		Outside Diameter	Length
		Ref	Max
M6 - 1.0	M620RNCUPA2	10	20
M6 - 1.0	M625RNCUPA2	10	25
M6 - 1.0	M630RNCUPA2	10	30

Description	A cylindrical mechanical device that is completely threaded internally, from one end through to the opposite end. Round coupling nuts are less common than hex couplings.
Applications/Advantages	Used to join two externally threaded parts of equal thread diameter and pitch, often two pieces of stainless steel threaded rod. They are used when wrenching is not required and a smooth, outer appearance is preferred. Also referred to as rod couplings.
Material	A2 Stainless Steel
Plating	Stainless coupling nuts are typically supplied without any additional finish.