

METRIC FASTENERS

DIN 986 Domed
Nylon Insert Lock Nuts

NUTS

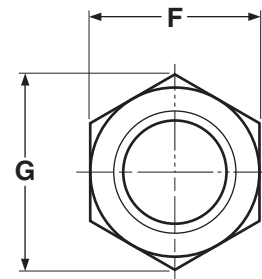
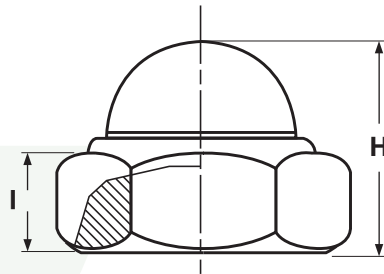

METRIC - DOMED NYLON INSERT STOP NUTS						DIN 986
Nominal Size	F		G	H		I
	Width Across Flats		Width Across Corners	Total Height		Wrenching Height
	Max	Min	Min	Max	Min	Min
M4 - 0.7	7	6.78	7.66	9.9	9.3	2.9
M5 - 0.8	8	7.78	8.79	10.85	10.15	4.4
M6 - 1.0	10	9.78	11.05	12.35	11.65	4.9

Description	A hex nut with a dome-shaped top (similar to an acorn) and a round collar where the hexagonal section and dome meet. Within this collar is a nylon insert. When a screw reaches the collar, the threads and nylon form a tight, frictional fit, restricting movement of the screw when it is subjected to vibration. The nylon insert comes in various colors.
Applications/Advantages	The nut serves multiple purposes. First, it acts as a locking nut due to the nylon insert deforming over the mating screw thread, enabling the fastening to resist vibration. It can also help to seal the fastening from seepage of liquids. Additionally, the domed top adds a decorative element to the fastening. The lock nut may be reused. The stainless material resists corrosion.
Material	<i>Stainless</i>
	A2 Stainless Steel