

## METRIC FASTENERS

DIN 1587 Domed  
Hex Cap Nuts

## NUTS

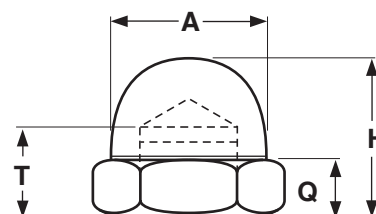
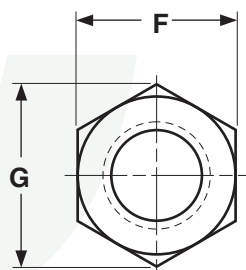

## METRIC - HEX DOMED CAP NUTS

Nominal Size	Thread Pitch	F		G	A	H		T		Q	
		Width Across Flats		Width Across Corners	Body Diameter	Overall Height		Drill Depth		Hexagon Height	
		Max	Min	Min	Max	Max	Min	Max	Min	Max	Min
M4	0.70	7	6.78	7.66	6.5	8	7.64	5.74	5.26	3.2	2.9
M5	0.80	8	7.78	8.79	7.5	10	9.64	7.79	7.21	4	3.7
M6	1	10	9.78	11.05	9.5	12	11.57	8.29	7.71	5	4.7
M8	1.25	13	12.73	14.38	12.5	15	14.57	11.35	10.65	6.5	6.14
M10	1.50	16	15.73	17.77	15	18	17.57	13.35	12.65	8	7.64
M12	1.75	18	17.73	20.03	17	22	21.48	16.35	15.65	10	9.64

<b>Description</b>	A one-piece hex nut with a dome-shaped top (similar in shape to an acorn) and a threaded hole at the opposite end.		
<b>Applications/Advantages</b>	Cap nuts serve two main purposes: (1) as decorative pieces, and (2) as covers for projecting threads.		
<b>Material</b>	Class 6 cap nuts shall be made from a low-carbon steel which conforms to the following chemical composition requirements-- <b>Carbon:</b> 0.50% max.; <b>Phosphorus:</b> 0.060% max.; <b>Sulfur:</b> 0.150% max..	A2 Stainless	A4 Stainless
<b>Hardness</b>	<b>M3 - M16:</b> Vickers HV 150 - 302 (Rockwell B 78.7 - C 30) <b>over M16 - M24:</b> Vickers HV 170 - 302 (Rockwell B 85 - C 30)	-	-
<b>Plating</b>	See Appendix-A for information about the plating of steel cap nuts.	Stainless cap nuts are typically supplied without any additional finish.	