

CAP SCREWS & BOLTS

ELEVATOR BOLTS

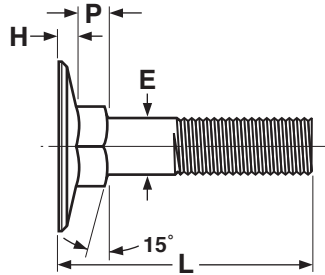
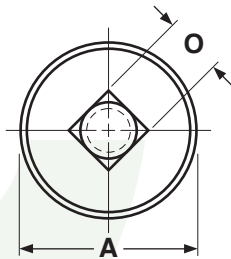

±Length of an elevator bolt is measured from the top of the head to the extreme end of the bolt.

ELEVATOR BOLTS											ASME B18.5-2012	
Nominal Size	E		A			H		O		P		
	Body Diameter		Head Diameter			Head Height		Square Width		Square Depth		
	Max.	Min.	Max. Edge Sharp	Min. Edge Sharp	Min. Edge Flat	Max.	Min.	Max.	Min.	Max.	Min.	
1/4	0.260	0.237	1.008	0.969	0.938	0.098	0.078	0.280	0.245	0.219	0.188	
5/16	0.324	0.298	1.227	1.188	1.157	0.114	0.094	0.342	0.307	0.250	0.219	
3/8	0.388	0.360	1.352	1.312	1.272	0.145	0.125	0.405	0.368	0.250	0.219	
7/16	0.452	0.421	1.477	1.438	1.397	0.176	0.156	0.468	0.431	0.281	0.250	
1/2	0.515	0.483	1.602	1.562	1.522	0.176	0.156	0.530	0.492	0.281	0.250	

Tolerance on Length	Nominal Bolt Size	Nominal Bolt Length		
		Up to 1 in., incl.	Over 1 in. to 2-1/2 in., incl.	Over 2-1/2 in. to 4 in., incl.
	1/4 thru 3/8	+0.02, -0.03	+0.02, -0.04	+0.04, -0.06
7/16 and 1/2	+0.02, -0.03	+0.04, -0.05	+0.06, -0.08	

Description	Bolt with a wide, countersunk flat head, a shallow conical bearing surface, an integrally-formed square neck under the head, and a unified thread pitch.
Applications/ Advantages	Popular use is in conveyor systems.
Material	AISI 1006 - 1050 or equivalent steel.
Core Hardness	<i>1/4 through 3/8 in. diameter, all lengths:</i> Rockwell B70 - B100
Proof Load	<i>1/4 through 3/8 in. diameter, all lengths:</i> 33,000 psi.
Yield Strength	<i>1/4 through 3/8 in. diameter, all lengths:</i> 36,000 psi. minimum
Tensile Strength	<i>1/4 through 3/8 in. diameter, all lengths:</i> 54,000 psi. minimum
Elongation	18% minimum (all sizes)
Reduction of Area	35% minimum (all sizes)
Minimum Thread Length	The minimum length of thread shall be equal to twice the basic bolt diameter plus 0.25 in..
Plating	See Appendix-A for plating information.